

Circular bends

AL-90°



Description

Circular segmented and lockseamed bends are used to install a ventilation system in buildings along with spiral or smooth ducts. The products can be made of: galvanized steel sheet - corrosion class C3-L / C2-M; sheet with aluminium zinc coating - corrosion class C4-M / C3-H; stainless steel sheet AISI 304 (1.4301) or AISI 316L (1.4404) - corrosion class C5. Bends is made with double seal gasket EPDM with self-slip material inside. Tightness class C according to LST EN 1506 and LST EN 12237. The bends can be used at temperatures from -45 to +85 °C with appropriate insulation. The maximum permissible absolute humidity inside the air stream and outside is 18 g/kg. Bends can be manufactured in 90°, 60°, 45°, 30°, 15° angle modifications.

Ordering code

Galvanized steel -	AL200-90
AISI 304 - NP	
AISI 316L - 316NP	
Product	
Size	
Angle	

Sample: NPAL200-90 – made of AISI 304 steel, circular bend, diameter 200 mm, angle 90°.

Dimensions

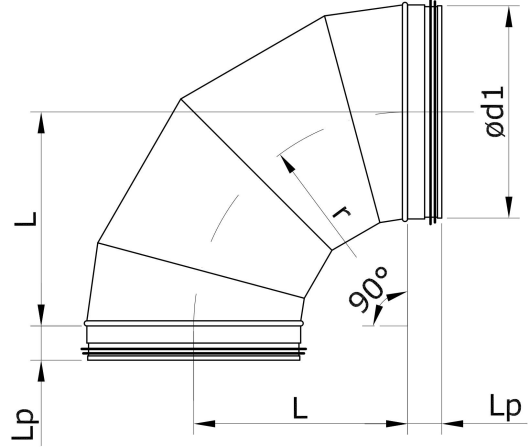

$r = d1$

Ød1 _{nom} [mm]	L [mm]	s [mm]	Lp [mm]	Mass [kg]	s _{np} [mm]	Mass _{np} [kg]
200	200	0,5	40	1,50	0,5	1,52
250	250	0,5	40	2,10	0,5	2,12
315	315	0,5	40	2,80	0,5	2,82
355	355	0,5	50	3,31	0,5	3,34
400	400	0,5	50	4,21	0,5	4,25
450	450	0,5	50	5,12	0,5	5,16
500	500	0,5	50	6,11	0,5	6,17
560	560	0,5	50	7,53	0,5	7,64
630	630	0,6	50	11,2	0,5	9,92
710	710	0,7	65	16,3	0,6	14,4
800	800	0,7	65	20,3	0,6	18,3
900	900	0,7	100	26,3	0,6	22,7
1000	1000	0,9	100	41,1	0,8	36,7
1250	1250	0,9	100	62,3	0,8	55,6

Mass_{np} – product mass made of stainless steel

Technical data

