



TECHNIKA

Rectangular smoke duct bends 90°

DSK-AF90



Description

The rectangular smoke duct section bend DSK type is used to install single smoke and heat duct systems where smoke and heat need to be removed and extracted. The bends distribute the air evenly when the smoke duct needs to be rotated 90°. Products can be made of: galvanized steel sheet - corrosion class C3-L/C2-M; sheet with aluminium zinc coating - corrosion class C4-M/C3-H.

The products are CE marked according to the standard LST EN 12101-7 and are used in smoke and heat control systems (for more information see the product declaration).

Maximum smoke duct section width x height, [mm]	Classification according LST EN 13501-4
≤ 1250x1000	E₆₀₀ 120 (h_o) S1500 single

Ordering code

..... DSK-AF90-500300

Galvanized steel-
Aluminium zinc-AZ
Product
Size

Dimensions

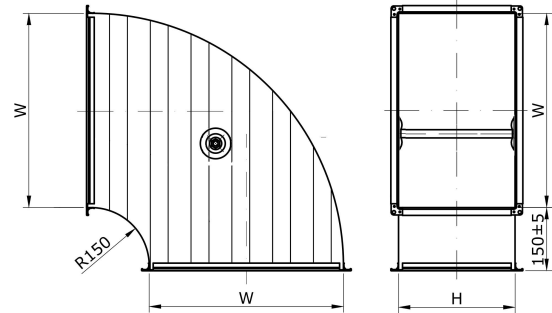

	W [mm]	H [mm]
Minimum dimensions	200	200
Maximum dimensions	1250	1000
Connection flange	F30	

Technical data

Large-sized smoke duct section bends are internally reinforced with rods. All smoke duct section bends are internally reinforced with internal plates for higher stability and better aerodynamic. Surfaces is made with reinforcement, stiffened with transverse trapezoid corrugations, resulting in low self-noise and greater resistance to pressure vibrations. The pressure losses of the rectangular system are calculated using data from circular ducts. Calculate the cross area and take the nearest smaller cross area of the circular duct.

Weight formula [kg] (galvanized steel)	W [mm]	H [mm]
$m[\text{kg}] = 16 \cdot W[\text{m}] + 11,5 \cdot H[\text{m}] \cdot W[\text{m}] + 3 \cdot H$	Up to 1100	Up to 1000
$m[\text{kg}] = 17,2 \cdot W[\text{m}] + 13 \cdot H[\text{m}] \cdot W[\text{m}] + 3,5 \cdot H$	From 1101 to 1250	Up to 1000

Sample: DSK-AF90-500300 – made of galvanized steel sheet rectangular smoke duct section bend 90°, WxH-500x300 mm.