

# Roof hood - confuser

KON



## Description

The confuser is used for exhaust air above the roof, suitable for both industrial and domestic ventilation. The air is vented upward. This prevents air contamination around the confuser. The confuser can only be installed in a continuous ventilation system.

NOTE! When the fans are not running, there is always the risk of snow and moisture penetrating the ducts. In some cases it can also cause condensation. The products can be made of: galvanized steel sheet - corrosion class C3-L / C2-M; sheet with aluminium zinc coating - corrosion class C4-M / C3-H; stainless steel sheet AISI 304 (1.4301) or AISI 316L (1.4404) - corrosion class C5. It has a mesh on outlet and an internal rain funnel, which is designed to drain rainwater and snow through a drain pipe. The confuser is made with an internal connection that fits into standard ventilation ducts. The confuser can be used at temperatures from -45 to +85 °C. The maximum absolute humidity inside and outside the air flow is 18 g / kg. Starting from size 500 confuser is made with lifting lugs that are designed for lifting and tensioning up to 1000 N.

## Ordering code

Galvanized steel -	..... KON200
AISI 304 - NP	
AISI 316L - 316NP	
Product	
Size	

Sample: KON200 – made of galvanized steel circular confuser, dimension 200 mm.

## Dimensions

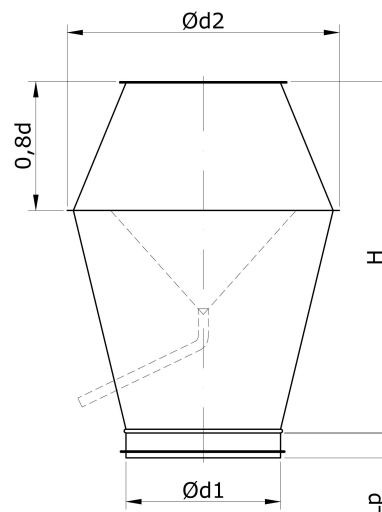

Ød1 [mm]	Ød2 [mm]	H [mm]	Lp [mm]	Mass [kg]
100	165	225	40	1
125	206	281	40	1,3
160	264	360	40	1,6
200	330	450	40	2,3
250	413	563	40	4,6
315	520	709	40	7,2
355	586	799	65	9,6
400	660	900	65	11,5
450	743	1013	65	17
500	825	1125	65	20
560	924	1260	65	28
630	1040	1418	65	34
710	1172	1598	65	52
800	1320	1800	65	65

## Technical data

