



TECHNIKA

Insulated access doors

PRAV



Description

Rectangular insulated access doors are used to install a ventilation system in buildings along with rectangular ducts and, with the use of a saddle branch, to round spiral ducts. Access doors are used for cleaning and inspection of important elements. The products can be made of: galvanized steel sheet - corrosion class C3-L / C2-M; sheet with aluminium zinc coating - corrosion class C4-M / C3-H; stainless steel sheet AISI 304 (1.4301) or AISI 316L (1.4404) - corrosion class C5. The construction consists of two parts, a housing and a cover made of 50 mm stone wool covered with fibre glass. The seal is ensured by a closed-cell polyethylene sealing gasket. The door can be installed for outdoor ducts as well. Access door tightness class B according to LST EN 1507. It is also possible to order a product with a higher C tightness class. Access door can be used at temperatures from -45 to +85 °C. The maximum permissible absolute humidity inside and outside the air stream is 18 g / kg. For other dimensions and materials please contact UAB „MKTechnika“ sales offices.

Ordering code

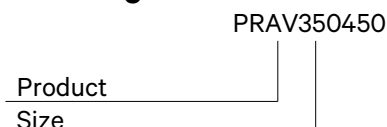

Sample: PRAV350450 – made of galvanized steel insulated with mineral wool access door, dimensions 350 x 450 mm.

Dimensions

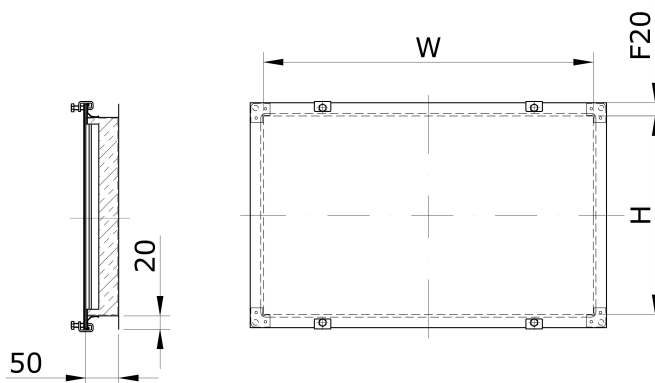

| Name | H* [mm] | W* [mm] | Mass [kg] |
|------------|---------|---------|-----------|
| PRAV80350 | 80 | 350 | 1,1 |
| PRAV150350 | 150 | 350 | 1,3 |
| PRAV350450 | 350 | 450 | 2,5 |
| PRAV550450 | 550 | 450 | 3,1 |

* - dimensions of the opening in duct

Technical data

The minimum dimensions of the access openings in rectangular ducts according to LST EN 12097 are given below.

| Rectangular or oval opening | |
|-----------------------------|--|
| Duct wall height s [mm] | Minimum dimensions of the access openings w x h [mm] |
| s ≤ 200 | 300x100 |
| 200 < s ≤ 500 | 400x200 |
| s > 500 | 500x400 |

