

Filter box

SFDK



Description

SFDK filter boxes are used for supply air cleaning with filters inside, classes ISO Coarse 70%, or ePM10 70%, or ePM2.5 70% according to ISO 16890. The filter is easily replaced with the top cover removed. SFDK type filter boxes are designed for installation in rectangular duct systems.

The products can be made of: galvanized steel sheet - corrosion class C3-L / C2-M; sheet with aluminium zinc coating - corrosion class C4-M / C3-H; stainless steel sheet AISI 304 (1.4301) or AISI 316L (1.4404) - corrosion class C5. The tightness class of standard filter box is B according to LST EN 1507. The filter box can be used at temperatures from -45 to +70 °C with appropriate insulation.

Ordering code

Galvanized steel - AISI 304 - NP SFDK300200Coarse
AISI 316L - 316NP	
Aluminium zinc - AZ SFDK300200Coarse
Product	
Size SFDK300200Coarse
With filter - Coarse, ePM10, ePM2,5	

Dimensions

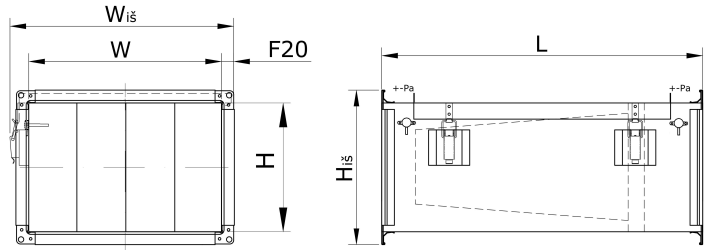

Dimensions of connection [mm]	W [mm]	H [mm]	L [mm]	W _{is} [mm]	H _{is} [mm]	Mass [kg]
300x150	300	150	450	355	190	4,5
300x200	300	200	450	355	240	5,0
400x200	400	200	450	455	240	5,9
400x300	400	300	450	455	340	6,8
500x250	500	250	450	555	290	7,2
500x300	500	300	630	555	340	9,4
600x300	600	300	630	655	340	10,5
700x400	700	400	730	755	440	14,1
800x500	800	500	730	855	540	16,5
1000x500	1000	500	730	1055	540	19,0

Technical data

It is recommended to install the filter box as the first element of the system that will clean the air from dust and other components in the system (fan block, damper, electric or water heater) to protect against dirt. According to the standard LST EN 13779, permissible pressure losses through the filter Coarse - 100 Pa, ePM10 - 150 Pa, ePM2.5 - 250 Pa. The lower the pressure, the lower the electricity consumption will be in the ventilation system.

Product	Filter dimensions [mm], (width x height x pocket length - quantity, possible filter class)
300x150	290x140x360-3, Coarse 70, ePM10, ePM2,5
300x200	290x190x360-3, Coarse 70, ePM10, ePM2,5
400x200	390x190x360-4, Coarse 70, ePM10, ePM2,5
400x300	390x287x360-4, Coarse 70, ePM10, ePM2,5
500x250	490x240x360-5, Coarse 70, ePM10, ePM2,5
500x300	490x287x535-5, Coarse 70, ePM10, ePM2,5
600x300	592x287x535-6, Coarse 70, ePM10, ePM2,5
700x400	690x390x635-7, Coarse 70, ePM10, ePM2,5
800x500	792x490x635-8, Coarse 70, ePM10, ePM2,5
1000x500	892x490x635-9, Coarse 70, ePM10, ePM2,5

Sample: SFDK300200Coarse - made of galvanized steel sheet, rectangular filter box with connection 300x200 mm with filter class - Coarse 70%.

Filter box

SFDK

Pressure measurement

The standard filter box is equipped with pressure measuring nozzles, which make it possible to determine the level of pollution of existing filters. Any mechanical or liquid manometer can be connected to these nozzles. The pressure gauge display allows you to see the pressure drop through the filter and plot the filter change based on the measured real numbers. The lower the system pressure drop, the less power is consumed by the power supply or exhaust fans. If required, the SFDK filter box can be ordered with one of two possible types of manometer:

1 – The mechanical manometer is intended for use in rooms where the air temperature is from -5 to +60 °C. Measurement accuracy 2% of value.



2 – The liquid manometer is intended for use indoors or outdoors, protected from the effects of water or snow, where the air temperature is from -40 to +60 °C. Measurement accuracy 10 Pa.



Technical data

With Coarse 70% clean filter

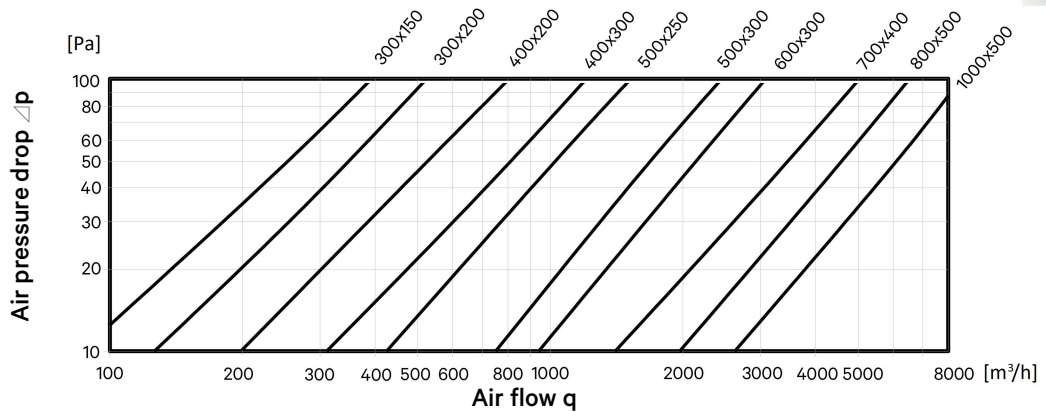

With ePM10 70% clean filter

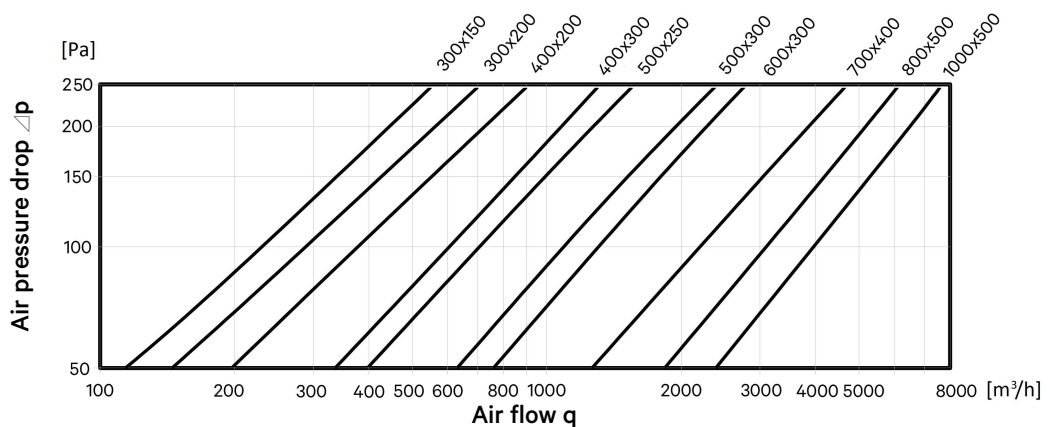

With ePM2,5 70% clean filter

